

CHOOSE YOUR OWN ADVENTURE



HOW TO USE THE GUIDE

This visual guide is meant to help young guests, guests with disabilities and their families plan their visit to the zoo. It is designed to be printed and arranged in an order that supports you during your zoo visit. Simply remove any pages that do not apply to you. The pages for snack and break can be dispersed anywhere in the story, and you can print more than one if needed!

We also included sensory triggers to help prepare those with sensitivities for a successful zoo trip. Look for these symbols to help you prepare:



Loud noises



Smelly



**Animals up close/
lots of movement**

Once you have arranged your social story, we suggest reading it a few times before your visit. This will help you know what to expect and have a better zoo visit.

The “Choices” page at the end of this social story has photos for other needs you may have during your visit.

TIPS

- If you or someone in your group is sensitive to noise and crowds, it is best to visit the zoo during the fall and winter when it is less crowded, or early in the morning before too many people arrive. Weekday afternoons (after school groups have left the zoo, around 3 p.m.) can also be a calm time to visit the zoo. You will find a sensory map at the end of this guide that can help you to find quiet spaces even during busy times at the zoo.
- When purchasing tickets, ask for the disability discount for any guests with disabilities. This is \$2 off your admission price.

- If you or someone in your group would benefit from sensory tools such as noise-canceling headphones, weighted blankets, fidgets or pinwheels, you may want to start your zoo adventure at Zoomazium or Guest Services where you can borrow these tools.
- Woodland Park Zoo spreads over 92 acres! Because of its size, it can be challenging to see everything in one day. A little planning can help you to enjoy the parts of the zoo that matter most to you! It can also mean a lot of walking, so comfortable shoes are a must!
- If someone in your group uses a wheelchair, you will want to look at the

accessibility guide for route suggestions and terrain. Wheelchairs can access most areas, but it can be challenging for some users. Also note that an accessible parking placard qualifies you to park in any spot at the zoo for no charge – so the “Parking” page would not apply to you!

- When you first enter the zoo, take a picture of the “Today’s Programs” board near the entrance. This will help you know the location and time of any programs you want to see.
- The #5 bus stops at N. 55th Street and Phinney Avenue N, right by the zoo’s West Entrance. Taking the bus is a great way to reduce carbon emissions!



GETTING READY

When I come to the zoo I come prepared to have a great day. I put on my comfortable shoes. The zoo is big! Sometimes we will walk a long time to see animals. If I get tired, I can ask for a break.

I bring sunscreen, snacks, water and a rain jacket. I can bring a special stuffy or fidget that helps me stay calm.

RAINY DAY

If the weather is not great at the zoo, that is ok! There are lots of animals to see inside buildings while we wait for the weather to get better.



IMPORTANT RULES

There are some important rules at the zoo to keep the animals safe and comfortable. (That means I will see more of them!)

- 1** Stay on marked paths and in guest areas.
-

- 2** Do not throw food or objects into animal habitats. They have their own healthy food!
-





-
- 3 Do not tap on the glass. If you want to see animals better, try waiting quietly or going to a different viewpoint!
-

- 4 Use quiet voices near animals.
-

- 5 Use recycling, compost and waste containers throughout the zoo.
-

I can follow these rules to make sure everyone has a good time at the zoo!





SEEING ANIMALS

Being patient can be hard, but I will wait politely to view the animals. I remember that other people are trying to see the animals too.

It is okay if I don't see every animal at the zoo. Animals like to have choices just like I do, so if I do not get to see an animal I remember it is their choice!



STAYING SAFE

If I need help, I can ask staff or volunteers at the zoo. I can also ask them questions about animals! Staff at the zoo wear a **GREEN** shirt or sweatshirt and **TAN** pants. They might also wear a **GREEN** jacket. I can tell someone is a volunteer because they wear a **TAN** vest with lots of pockets or a **BROWN** shirt.





BORROWING TOOLS

I can borrow tools at Zoomazium or Guest Services to help me stay calm. I ask the zoo staff at the front desk to see the sensory bin, and choose something that will help me have a great day. When I am done at the zoo, I give the tools back at Zoomazium or Guest Services.

BATHROOMS

There are bathrooms all over the zoo. If I need to use the bathroom, I tell my group. We can look at the map to find one, or we can ask staff or volunteers at the zoo. All of the bathrooms have an accessible stall.

Some bathrooms are family bathrooms, so there is room for someone to help me!

Those bathrooms are on the accessibility map (at the end of this guide).





BREAK

The zoo is a fun place for me to visit, but sometimes it can be overwhelming. I make sure I tell the people I am with if I am tired or uncomfortable. If I need a quiet break or space to move my body, I can find great places to rest or run and play. I can use the sensory map (at the end of this guide) or ask an adult for help finding a break place. It is okay to take breaks. Animals take breaks too!





SNACK

I brought snacks to the zoo. When I am hungry, I can tell my group. We find a place to eat a snack. I make sure to keep my snack to myself – animals have their own healthy meals!

When I am done with my snack I help keep the animals safe by using the recycling, trash and compost bins.





PARKING

Today I am going to the zoo!

I begin my visit in the parking lot, and look for the parking kiosks.

This is where we pay for parking. There might be a line, so we need to wait our turn.

We put the ticket back in our car.



TAKING THE BUS

Today I am going to the zoo!

We ride the bus because it is good for the environment! I make sure my group knows how to get to the zoo.

When the bus is close to the zoo, I pull the cord to let the driver know to stop.



ENTRY

This is the entrance, where I wait in line for tickets. I show zoo staff my ticket on the way in.

Guest Services is close to the entrance. This is where we can rent strollers, wagons and wheelchairs. I can find zoo staff here if I get lost or hurt.





ZOOMAZIUM

Zoomazium is a building where kids can learn and play. Big kids always need to watch out for little kids.





CREATURE FEATURE

I can see Creature Feature in Zoomazium every day at 10:30 a.m. Zoo staff tells an animal story. I listen quietly during the story. After the story I can meet the animal up close! If I want to touch the animal, I wait in line with the other kids. I am quiet near the animal to help them to stay calm. When it is my turn staff helps me touch the animal with one or two gentle fingers.

After I touch the animal I use foamy soap to clean my hands.





PENGUINS

I can see penguins above and below the water. Penguins are great swimmers! Penguins sometimes call to each other. They are very loud for such small animals! Penguins eat fish, so they smell fishy – especially their poop!





PROGRAMS AT ALVORD BROADLEAF THEATER

I get to see animals up close with their keepers at zoo programs. There might be lots of people at the program. I sit down in my seat and am quiet to hear the animal keeper. Quiet voices help the animals stay calm and comfortable.

After the program, I wait my turn to see the animal up close and take pictures. I listen to the staff's instructions to keep the animals safe.





PROGRAMS AT WILDLIFE THEATER

I get to see animals up close with their keepers at zoo programs. There might be lots of people at the program. I sit down in my seat and am quiet to hear the animal keeper. Quiet voices help the animals stay calm and comfortable.





BUTTERFLY GARDEN *(seasonal)*

I can see lots of different butterflies all around me! I am extra close to the animals here, so there are some special rules. I am careful where I walk to keep the butterflies safe. I will not touch the butterflies because I don't want them to get hurt.

When I enter the Butterfly Garden I let the doors behind me close before I go through the curtain. This helps the butterflies to stay in the exhibit. I can hold very still and see if butterflies will land on me. I am not supposed to chase them, but if they land on me it is okay.

When I am ready to leave, a staff member in a green shirt asks me to turn around in a circle. They make sure the butterflies do not ride out of the garden on my clothes! I remember to be careful with the doors on the way out too!





TROPICAL RAIN FOREST

I may see gorillas, monkeys, jaguars and lemurs. When I see animals I do not tap on the glass. I can see animals better when I am quiet and calm.



Lemurs sometimes make loud barking noises. If it gets too loud, I tell my group and we go somewhere else.

In the rain forest dome I feel the warm, humid air. I might even get a little wet! It can be crowded in this building. I let my group know if I am uncomfortable. I enter the aviary and let the door close behind me, then I step through the beaded curtain.





BANYAN WILDS

I may see otters, tigers and sloth bears!

There is a playground where I can move my body and play! I ask my group if I want to climb and play here.





TEMPERATE FOREST

I may see red pandas, pudus,
maned wolves and many birds!

I can smell the flamingos
even before I see their pink
feathers. If I don't like the
smell, we can move on.

I smell a skunky odor when I
get near the maned wolves.
They use this smell to tell
other animals where their
territory is. If I don't like the
smell, we can move on.

In the marsh aviary I can buy
snacks to feed the ducks for
25 cents!





HABITAT DISCOVERY LOOP

There are spaces to play and climb here! If I want an active break from seeing animals, I ask my group. The play structures look like different animal homes, so I can climb like a spider, dig like a meerkat or rest in a nest.



AVIARIES

Aviaries are open spaces where birds can fly. I will be in the same room as the birds. When I enter an aviary I go through two sets of doors. I close the doors behind me before I open the next doors. That way the birds will not get out!

Birds might get close to me in the aviary. They might surprise me when they sing or fly, but they will not hurt me. If I move quickly or make loud noises, it can make the birds fly around. If I don't like the aviary, I leave calmly. There are aviaries in the African Savanna, Tropical Rain Forest, Temperate Forest and Australasia.





FAMILY FARM

In the summer I can go to the Family Farm. I smell the manure in the animals' pens. I pet the goats and sheep gently. I pet them below their collar, not on their heads. Sometimes the goats are loud!

They will walk around their pen. I move slowly so I do not scare them. If they get surprised they might run around. They have a break area for when they want to be alone, I give them space if they are taking a break. If I get uncomfortable, I can leave the Contact Area to take a break too!





AFRICAN SAVANNA

In the Savanna Overlook
I see what my house and
school might look like if I
lived in Kenya. I explore the
buildings here, there is lots
to see and touch.

I may see Giraffes, hippos,
zebras, and patas monkeys.
If I am lucky, I might hear the
hippos laugh or the lions roar!





ASSAM RHINO RESERVE

The rhinos have a big outdoor habitat that includes a mud wallow they love to roll in. I can look into their barn and see where the rhinos sleep and shower.



During the summer I can buy a snack to feed the rhinos! I listen to the animal keepers' instructions to help me meet the rhino safely.



TRAIL OF VINES

I may see tapirs, orangutans, siamangs and a python in the Trail of Vines. I don't tap on the glass. To see animals better I move to a different angle, or wait quietly. I see animals better when I am quiet and calm.



Siamangs can be very loud when they talk to each other. They are letting each other know they are safe and where they are. If they are too loud for me, I can wear headphones or move on to a different part of the zoo.





AUSTRALASIA

I may see emus, wallabies and wallaroos. Sometimes the emus make a noise like a drum. I keep my hands to myself near the emus, because they can bite my fingers!



Next to the emu yard I get a different look at wallabies and wallaroos and see Australian birds. The kookaburra might make his loud laughing noise.



Nearby is the snow leopard exhibit. Snow leopards have amazing camouflage. I look carefully for the snow leopards.





WILLAWONG STATION

Willawong Station is a special aviary with lots of birds. The birds are colorful and friendly. They are used to humans so they will get close to me. The birds call loudly to each other, and sometimes they move quickly, especially if they are surprised. There is a bird smell, and since the birds are flying around they may poop on me! I move slowly to keep the birds calm, and watch my step to keep the birds safe.

If I want to see the birds more closely I buy a seed stick. I hold it out still. The birds see the seeds and may land on the stick or my hand.





NORTHERN TRAIL

I may see bears, otters, mountain goats and raptors. If I look all around me in the Northern Trail I see animals from different angles, and they see me!

I enter a building to see where the bears and otters play in the stream. The building can be very loud when there are lots of people, I go in the morning if I want it to be quieter.

If I need a quiet space in Northern Trail, the Tundra Center is usually a good spot to rest. It also has family bathrooms!





ADAPTATIONS

I may see bats, Komodo dragons, sloths and meerkats. It is great to visit here when it is raining! It has a long hallway, and when it is busy can feel cramped. I let my group know if I am uncomfortable.





LUNCH

When I am hungry I can tell my group, and we can find a place to eat! We can buy food, or eat food we brought. There are places to eat outside or inside 1899 Grove. Lunch time at the zoo can be noisy, especially near the food pavilion. If I want a quieter place to eat I tell my group, and we find other picnic tables.

When we are done eating, I use the recycling, trash and compost bins!





HISTORIC CAROUSEL

I can ride the carousel at the zoo. There are lots of lights and carnival music in the carousel pavilion. It can be very loud. I wait my turn to buy a ticket. When I find a seat I like, that is where I stay. I hold on and stay in my seat until the ride is over. I ride around in a circle and might bounce up and down. When the ride is over, I get up from my seat and we leave the carousel pavilion.





GOING HOME

When we are done at the zoo I get ready to go home. I had a great time at the zoo!

Coming to the zoo helps save animals in the wild! I can come to the zoo another time to see the animals and help the zoo save wildlife.

I return sensory tools at the gate on my way out. Goodbye zoo!

CHOICES

I can use the choices page to help tell people what I want and need. I can point to pictures to explain what I want.

BATHROOM



TOOLS



PLAY



BREAK



SNACK



LEAVE THE ZOO



SENSORY MAP

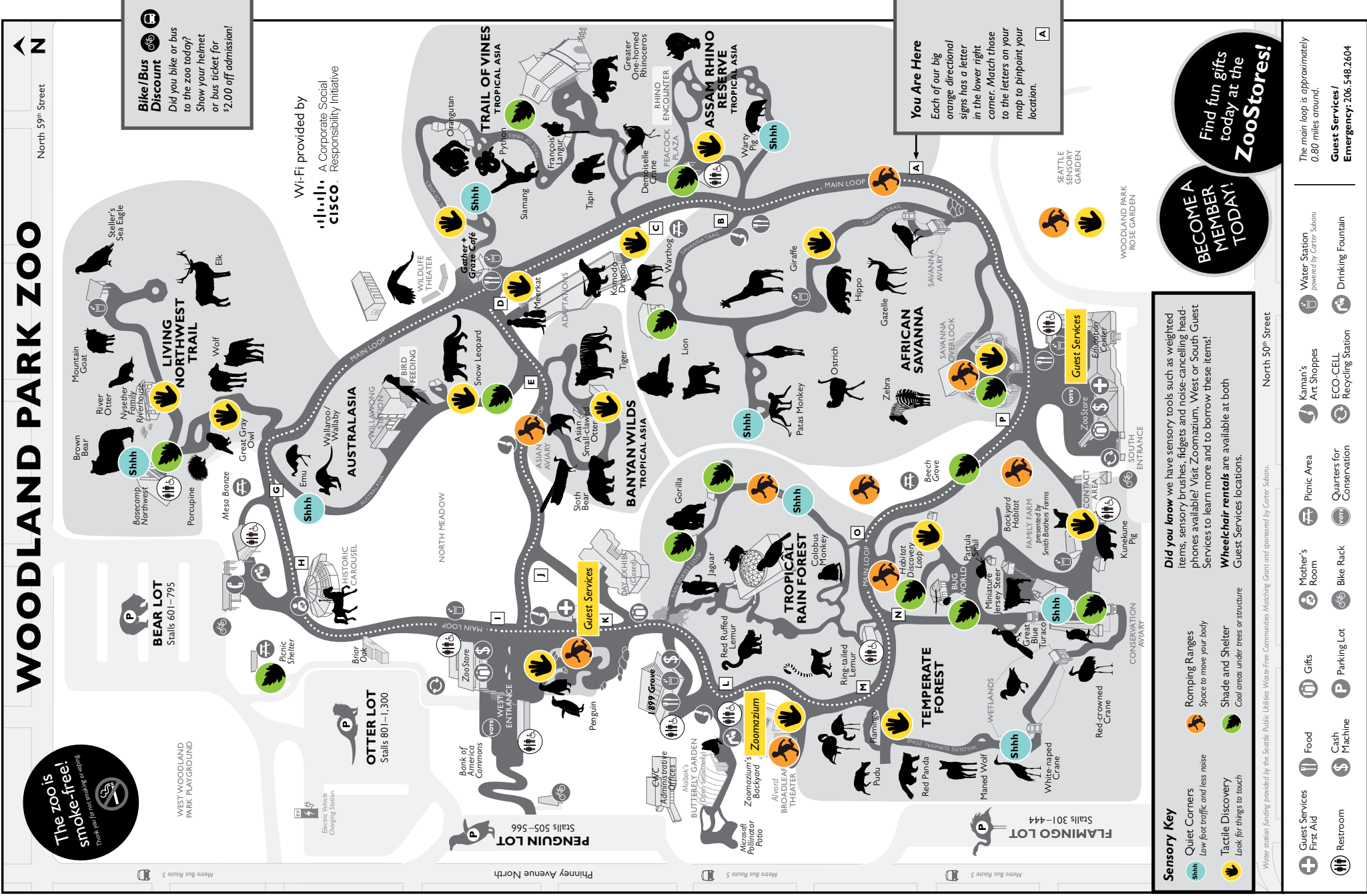

ACCESSIBILITY MAP AND GUIDE

WOODLAND PARK ZOO

North 59th Street



The zoo is smoke-free!
Thank you for not smoking or vaping.

WEST WOODLAND PARK PLAYGROUND

Bike/Bus Discount
Did you bike or bus to the zoo today?
Show your helmet or bus ticket for \$2.00 off admission!

Wi-Fi provided by
CISCO
A Corporate Social Responsibility Initiative

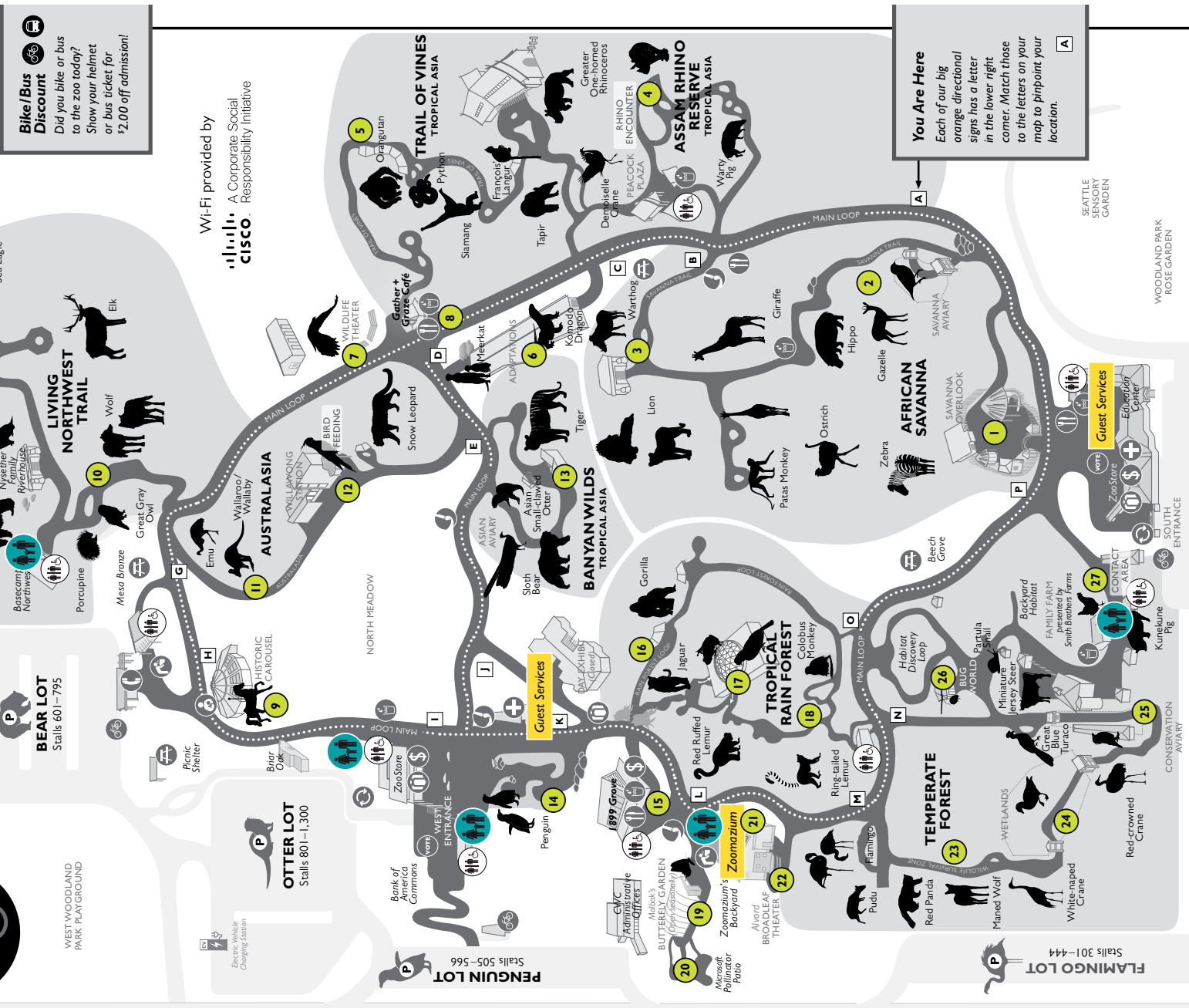

Accessibility Key

- 1** Trail Texture Guide
See numbered list on back
- 2** Family Restroom
Extra space provided

Did you know we have sensory tools such as weighted vests, pinwheels, fidgets and noise-canceling headphones available? Visit Zoomazium to learn more and to borrow these items!

Wheelchair rentals are available at both Guest Services locations.

BECOME A MEMBER TODAY!

Find fun gifts today at the ZooStores!

- | | | | | | | | |
|--|--|--|--|--|--|--|--|
| | | | | | | | |
| | | | | | | | |
- The main loop is approximately 0.80 miles around.
- Guest Services!**
Emergency: 206.548.2604

HIPPO LOT
Stalls 1-271

Stalls 301-444

Stalls 505-566

Stalls 801-1,300

Stalls 601-795

You Are Here
Each of our big orange directional signs has a letter in the lower right corner. Match those to the letters on your map to pinpoint your location.